

45

CP-12

Punjab State Power Corporation Limited

(Regd. Office : PSEB Head Office, The Mall Patiala - 147001,
Corporate Identity Number : U40109PB2010SGC033813 Website: www.pspcl.in)

**OFFICE OF THE CHIEF ENGINEER/GGSSTP,
MATERIAL MANAGEMENT CELL-III, V&P.O. GHANAULI, ROOPNAGAR-140113
(FAX NO 01881-274232, PH NO 01881-275666)
(ISO 9001:2000 CERTIFIED)**

e-mail : se-monitoring-ggsstp@pspcl.in

To

Regd./Email

**Limited Tender enquiry
On various firm's as per overleaf.**

Memo No. 509/20 /P-3/EMP-11690

Dated: 13/2/20

Subject: - Procurement of different types of spares for wet ash handling system of stage II & III at GGSSTP, Ropar.

Enquiry No. 7166 /P-3/EMP-11690 dated: 13-2-2020

Date & Time of Receipt of Tender 12-3-20 upto 11.00 A.M.

Date & Time of Opening of Tender 12-3-20 at 11.30 A.M.

(In case opening date happens to be holiday, tender shall be opened on next working date at the same time)

Dear Sirs,

Please send your sealed quotation in duplicate in the Performa attached on the firm prices for the supply and delivery of items as detailed in Annexure-'A' enclosed. Enquiry No. and date of opening of tender must be legibly mentioned at right top corner of sealed cover. General terms & conditions shall be as per Annexure-'B' attached. Your quotation should be in two parts. For each item, unit rates should be quoted strictly on the attached performa of pricing schedule. Please note that if quoted rates are not as per attached performa, the offer is liable to be rejected. Insurance and freight charges should be quoted separately.

Also please note that competent authority may distribute the quantities to be procured on more than one firm.

The offer must be kept valid for at least 120 days

D/A- Annexure- A, B, Performa for Schedule of Deviation, Performa of pricing schedule & Sketch A to U

[Signature]
13/2/2020
DY:CE/Monitoring,

For CE/GGSSTP, Rupnagar

CC :-

- email* {
- 1) Dy.C.E./MMC-II, GGSSTP, Rupnagar along with Annexure-A to check specifications and intimate, if there is any discrepancy please.
 - 2) FA&CAO, GGSSTP, Rupnagar.
 - 3) Notice Board.

PUNJAB STATE POWER CORPORATION LIMITED

(Regd. Office : PSEB Head Office, The Mall, Patiala - 147001)

Corporate Identity Number U40109PB2010SGC033813 Website: www.pspcl.in

OFFICE OF THE CHIEF ENGINEER /GGSSTP,

MATERIAL MANAGEMENT CELL-3, V&P.O. GHANAULI, ROOPNAGAR-140113
Phone no. 01881-275666 E-mail: se-monitoring-ggsstp@pspcil.in

Annexure-'A'

ENQUIRY NO. 7166 IP-3/EMP-11690 DT. 13-2-2020

DETAIL OF MATERIAL AND TECHNICAL SPECIFICATIONS

| Sr. no. | GGSSTP Code no. | Description | Qty. reqd. |
|--|-----------------|--|------------|
| Spares for Ash Slurry Pump CD-135 stage-II | | | |
| 1 | 02070203 | Shaft For Ash Slurry Pump CD-135, Stage II as per sketch "A" | 1 |
| 2 | 02070205 | Gland Follower for Ash Slurry Pump CD-135 as per sketch "B" | 2 |
| 3 | 02070207 | Shaft Sleeve for Ash Slurry Pump CD-135 as per sketch "C" | 2 |
| 4 | 02070217 | Suction Adaptor Coupling for Ash Slurry Pump CD-135 as per sketch "D" | 2 |
| 5 | 02070228 | Lantern Ring for Ash Slurry Pump CD-135 for Stage II (Material Bronze ASTM-62) as per sketch "E" | 2 |
| Spares for ASP 85D,BAW Stage-II ,HP/LP pump stage-II& HP pump Stage-III | | | |
| 6 | 02070314 | Lantern Ring for Ash Slurry Pump D-85 D as per sketch "G" | 4 |
| 7 | 02080213 | SS-304 Shaft Sleeve for BAW Pump Stage II & III suitable for Beacon weir pump modal SDC 200/200 as per sketch "I" | 2 |
| 8 | 02080310 | Shaft Sleeve (DE) for BAW Pump Stage III as per sketch "J" | 2 |
| 9 | 02080201 | Shaft Sleeve for HP/LP pump Stage II as per sketch "L" | 2 |
| 10 | 02080229 | Gland Follower C.I HP/LP Stage II as per sketch "M" | 2 |
| 11 | 02080302 | Shaft Sleeve for HP Pump Stage III as per sketch "O" | 2 |
| Miscellaneous Spares | | | |
| 12 | 02080307 | Tyre Coupling Complete set & along with 2 no spare tyres with each set for seal water pump stage -III as per dimensions at Sr. no. 'a' of drg. Attached and specifications at Annexure "A" | 1 |
| 13 | 02080215 | Tyre for tyre coupling for LP pump of stage -III and BAW pump of Stage-II & III and as per dimensions at Sr. no. 'd' of drawing attached at Annexure "A" | 2 |
| 14 | 02030127 | Adaptor for nozzle as per sketch "P" | 15 |
| 15 | 02010221 | Inspection Window glass (toughened) as per sketch "R" | 4 |
| 16 | 02010134 | Shaft Sleeve for clinker Grinder as per sketch "S" | 20 |
| 17 | 02010167 | Bearing Housing Support for Clinker Grinder as per sketch "T" | 5 |
| 18 | 02090301 | Suction adopter for ash slurry pump D-85D Material C.I. as per IS-210 FG 260 as per sketch-'U'. | 2 |

Terms and Conditions:-

- 1) Fax/Telegraphic/e-mail tender shall not be accepted.
- 2) The tender shall be sent in two separate envelopes as under:-
 - (a) **Part-1-** One envelope containing deposit of Earnest Money (if applicable) & Technical /Commercial bids.
 - (b) **Part-2-** The other containing the prices.While opening the tenders the envelope containing the Earnest Money (if applicable) & Technical /Commercial shall be opened first and in case the deposit of Earnest Money (if applicable) & Technical /Commercial is in accordance with the terms of notice inviting tender only then second envelope containing the tender (prices) shall be opened.
- 3) **The tender must be accompanied by EARNEST MONEY (If applicable as per Annexure-B)**
- 4) The rates should be quoted on FOR destination basis giving break up of FOR Destination price as per **Performa of pricing schedule** attached.
- 5) The Performa for price schedule enclosed with specification shall be filled by tenderers duly typed and **hand written prices shall not be accepted.**
- 6) In addition to the break-up of total price i.e. ex-works cost, GST, Freight, Insurance and Packing the bidders should also give split up of ex-works price.
- 7) **Split up of ex-works prices shall indicate cost of raw material, Labour component and overhead expenses.**
- 8) Raw material can further be divided into 3-4 parts depending upon type of material.
- 9) The offer should be kept valid for 120 days from date of opening of tenders.
- 10) The bidders are not allowed to indicate over all discounts on the quoted price for which split up has been given as mentioned in Sr. No. 6 & 7 above. However, quantity/payment discount can be given by the tenderer in the main tender.
- 11) Any firm offering discount on the quoted price or after the opening of tender will be out rightly rejected.
- 12) Competent authority may distribute the quantities to be procured on more than one firm.
- 13) All pages of quotation should be duly signed.
- 14) Quantity can be increased or decreased.
- 15) Relevant literature/catalogue should be sent along with quotation.
- 16) **Negotiation shall not be held except with lowest bidder.**
- 17) Random testing of material on receipt in GGSSTP Store irrespective of the fact whether or not it was inspected before despatch shall be carried out by PSPCL. In case of any failure the entire lot shall be rejected at the risk and cost of the supplier.
- 18) Any deviation from PSPCL's standard terms and conditions be clearly mentioned in quotation under "**Schedule of deviations**" otherwise all terms and conditions will be deemed to have been accepted.
- 19) **Firm should mention GST number in their offer.**
- 20) The firm must mention HSN code of all items in their offer along with GST applicable on them. Uniform GST rates shall be applied while comparison of rates.
- 21) The location for the supply of goods/services must be in the territory of Punjab as goods are meant for use in Punjab.

22) Sourcing of service should be made from an agency with its office located in the territory of Punjab rather than merely from HQ of that agency. (which may be located outside the state).

23) **Tenders should enclose copies of Orders/Contracts against which they have supply same material to Thermal Plant of other states.**

24) Any firm which at the time of opening of the Tender enquiry, falls in any of the following categories, shall be regarded as defaulter and shall not be eligible for participation in any new Tender enquiry for a period of three years from the date of issue of Purchase Order in which it has defaulted:-

a) The Firm is a defaulter for the supply of 35% or more quantity on the date of expiry of the Contractual Delivery Period for the total ordered quantity.

b) The Firm is a defaulter for the supply of any quantity for more than 6 months from the date of expiry of the Contractual Delivery Period for the total ordered quantity.

This clause shall be applicable item wise (all types, sizes and ratings) against which the firm has become defaulter under the above said conditions.

25) Payments can be made through RTGS system of Digital Payments instead of cheques to the suppliers/firms/contactors whosoever gives the consent. All the bank charges related to RTGS are to be borne by the suppliers/firms/contactors.

26) **Firm which are registered with MSME are required to provide their registration certificate along with quotation. Please also note Clause no. 30(a) of Annexure-'B'**

27) **All other terms and conditions are as per Annexure - 'B' attached.**

[Handwritten Signature]
13/2/2022
DY.CE/Monitoring
GGSSTP, Rupnagar.

[Handwritten Signature]
13/2/2022
[Handwritten Mark]

ANNEXURE-C

SCHEDULE OF DEVIATIONS
(To be filled by tenderer)

Tenderer shall carefully state below any and all points in this proposal which are not in accordance with PSPCL's Technical Specification and the General Instructions:-

| Sr. No. | Para no. | Technical Deviation, if any. |
|----------|----------|------------------------------|
| 1. | | |
| 2. | | |
| 3. | | |
| contd... | | |
| Sr. No. | Para no. | General Deviation, if any. |
| 1. | | |
| 2. | | |
| 3. | | |
| contd... | | |

We hereby certify that the above mentioned are the only deviations from Purchaser's aforesaid specifications and general conditions.

Dated.

Authorized Signatory

Name: _____

Designation: _____

Address and Seal of the firm

Note: The tenderer is to clearly indicate any deviation in technical & general terms and conditions in this Annexure only. In case, the Technical Specification as well as General conditions of Tender Specifications are acceptable in toto, the word 'NIL' shall invariably be put in the above Columns. In case, nothing is mentioned here then it shall be presumed that there is no deviation in the offer and terms and conditions of the specifications are acceptable to the bidder in toto.

Performa of pricing schedule

BREAK UP OF F.O.R. DESTINATION PER UNIT PRICE
(THIS MUST ACCOMPANY THE TENDER DULY TYPED)

NAME OF TENDERER : _____

QUOTED QUANTITY : _____

NATURE OF PRICE : **FIRM**

| A) | Break-up | (Rs.) |
|-----|--|-------|
| 1. | Ex-works per unit price inclusive of packing forwarding (forming part of production) a) Cost of Major Component per item b) Cost of Minor Component per item. c) Cost of Labour charges per item. d) Overhead expenses per item. e) Packing charges forming part of production cost f) Any other charges | |
| 2. | GST @ _____ % | |
| 3. | Sub total (1+2) | |
| 4. | Packing cost (not forming part of production cost) | |
| 5. | GST @ _____ % | |
| 6. | Sub total (4+5) | |
| 7. | Forwarding charges. | |
| 8. | GST @ _____ % | |
| 9. | Sub total (7+8) | |
| 10. | Freight charges. | |
| 11. | GST @ _____ % | |
| 12. | Sub total (10+11) | |
| 13. | Insurance charges | |
| 14. | GST @ _____ % | |
| 15. | Sub total (13+14) | |
| 16. | Total (6+9+12+15) | |
| 17. | All-inclusive FOR Destination per unit Rate (3+16) | |

Note: 1. The firms should quote FIRM Prices only and offers of firms quoting variable prices shall be out rightly rejected

Name: _____

Designation: _____

Address and Seal of the firm

NOTES:

- i) If rate of GST in Para A is not given, the maximum applicable rate of GST, prevailing at the time of opening of tender, shall be taken into consideration.

- ii) The firms indicating NIL or concessional rate of GST in their tenders will have to absorb GST up to the full rate applicable at the time of tendering. The firm who do not agree to this stipulation or indicate GST as extra without indicating the applicable rate shall be loaded with maximum rate of GST for evaluation purpose.
- iii) In case quoted prices or any other declaration/ statement given in this annexure do not tally with the ones given in main tender or elsewhere, the ones given here shall be considered as the quoted price.
- iv) Any arithmetical error shall be considered to the advantage of the purchaser.
- v) The bidders shall not be allowed to indicate over all discount on the quoted price for which split up has been given. Any firm offering discount of the quoted price or after the opening of tender will be out rightly rejected.
- vi) The provisions of GST acts shall prevail upon wherever applicable in the terms and conditions of the specification.
- vii) The firm shall indicate the HSN code of each item.

CP-4
1-17

SKETCH A

GGS STP Code - 0207003

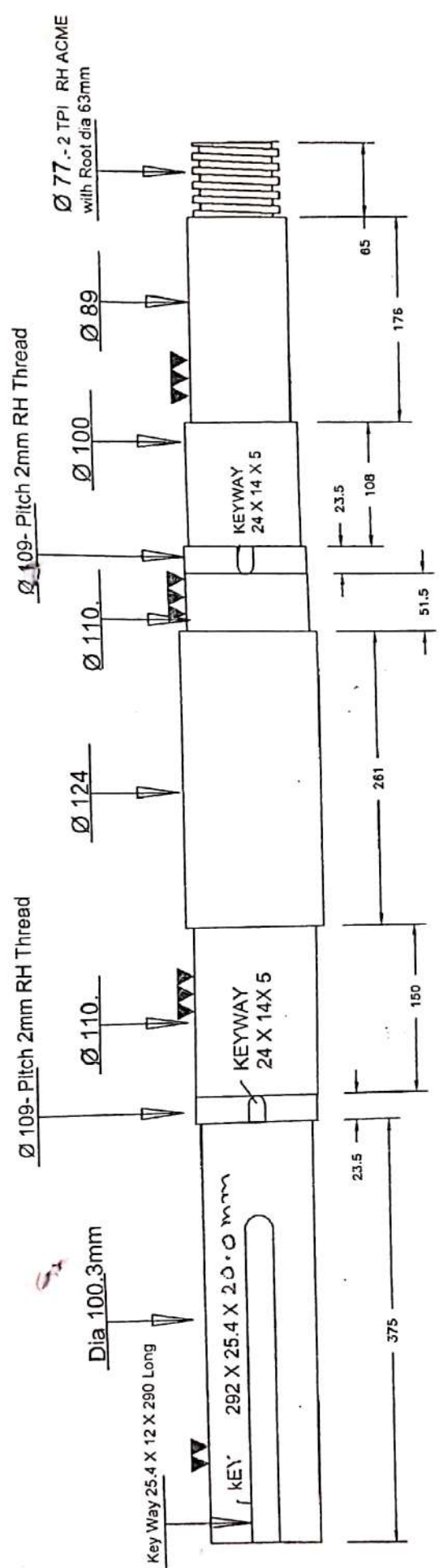

Ø142 thickness 20mm

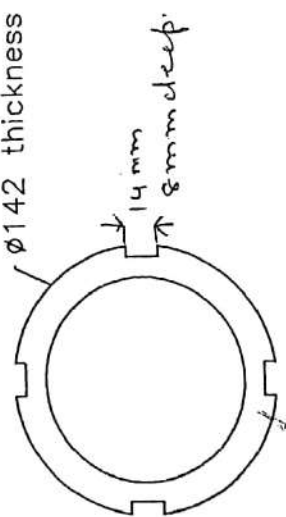

Lock Nut = 2 nos.
Material = M.S.

SHAFT FOR ASH SLURRY PUMP CD-13S FOR STAGE II

[Signature]
Sr. Xen. B-1-2

CP-4
2

MISSIP LOD 207205

79

SKETCH - B

SET OF GLAND HALF (Gland Follows) for CD 135 Ashstone Pump
GLAND HALF

02070205

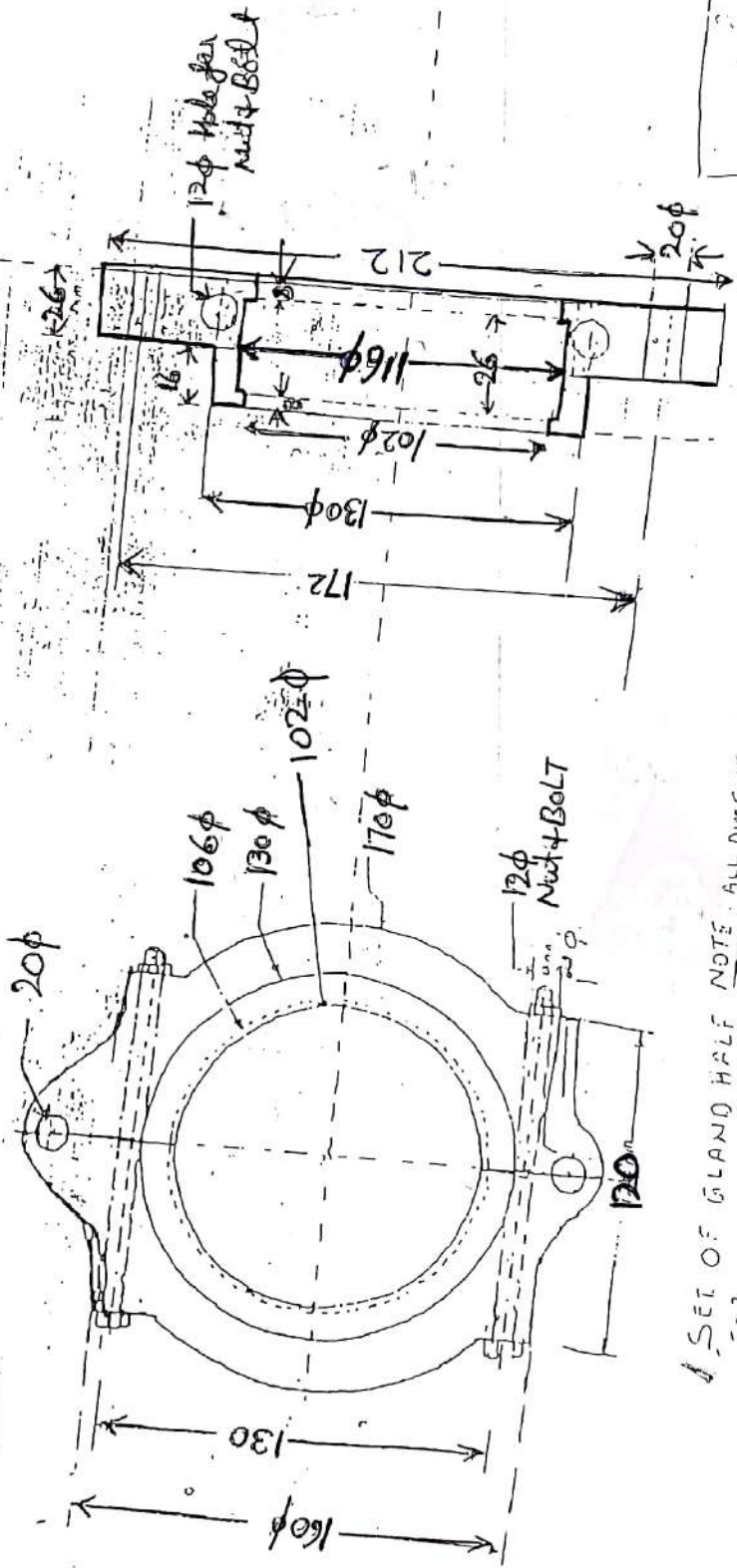

SET OF GLAND HALF NOTE: ALL DIMENSIONS ARE IN MM FOR CD-135 PUMP

(1) MATERIAL IS ASPEN IS-210 FG-300
(2) CASTING SHALL BE FREE FROM HOLE/ISSUES/CRACKS

(3) THE DRG IS FOR TENDERING PURPOSE ONLY. SAMPLE CAN BE SEEN AT STATE SITE FOR MANUFACTURING

GLAND HALF FOR PUMP

Signature
S. K. SINGH

CP-4
3

GIGSSFP code

02070207
OK

SKETCH 

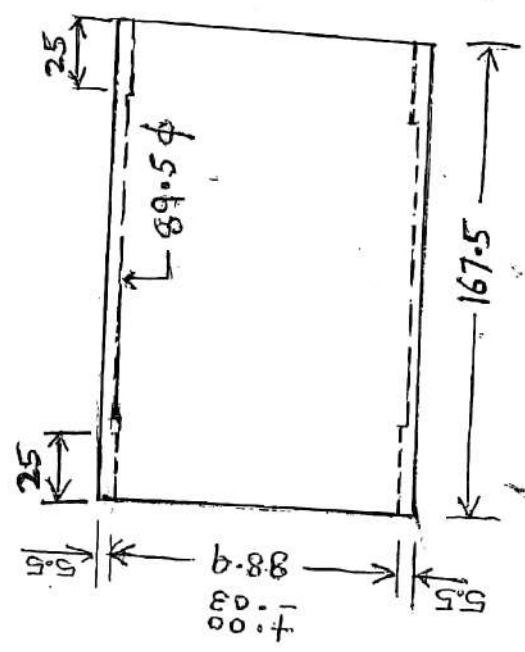

SAMPLE CAN BE SEEN AT
SITE BEFORE Manufacturing

MATERIAL SS-304

SHAFT SLEEVE FOR ASP (MODEL CD-135)

B.M. 2
Kotes

Shri. D. S. S.

CP-4
u

CP-4
3

SKETCH - D

Suction Adaptor CD-135

(3)
3

CODE
02070217

22-20X12 DEEP AT 100 PCD AND 16MM, 2NO. DRILLED HOLE INSIDE

8 NO, 18mm HOLE AT 300 PCD

200φ
315φ

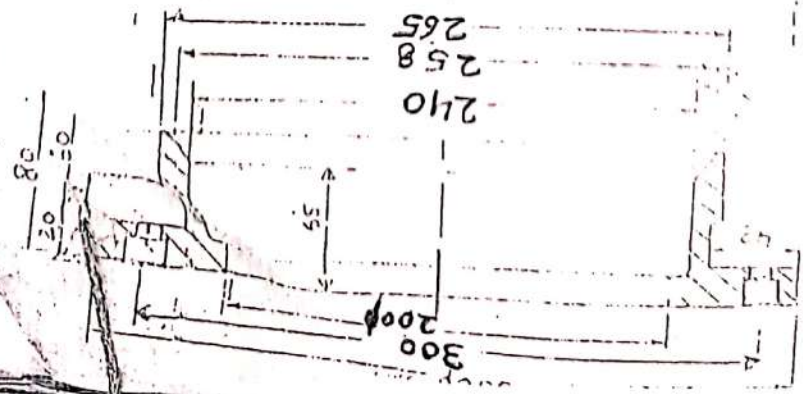
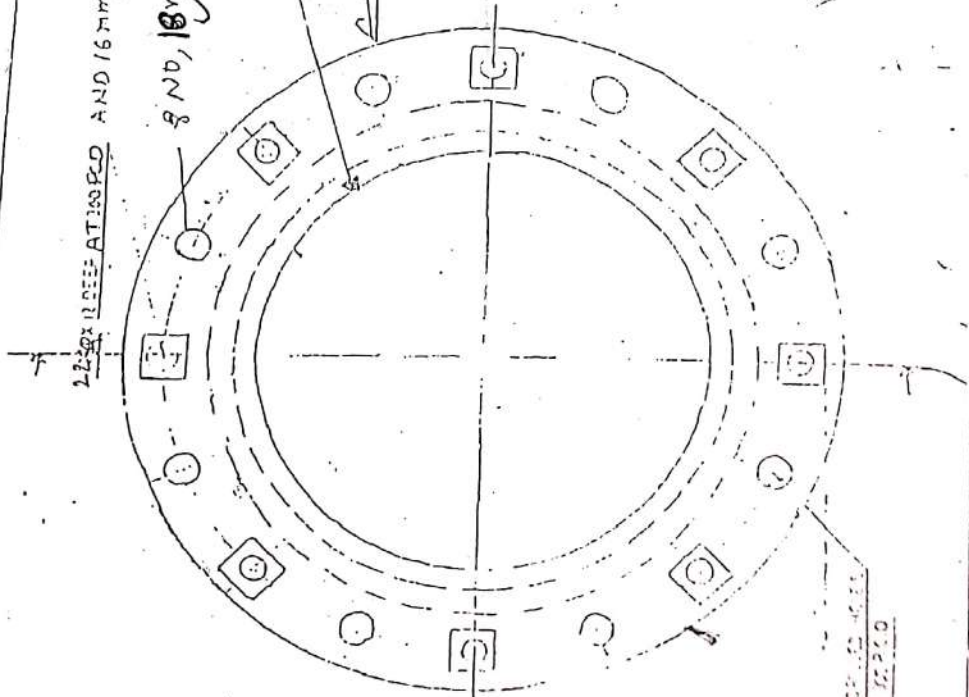

1. Material to be used is L20 FG 300
2. 12 no H.S Bolts with Hexagonal nut must be supplied with casting
3. The DRG is FOR TENDERING PURPOSE, ACTUAL SAMPLE CAN BE SEEN AT SITE FOR MANUFACTURING

Signature

Suction Adaptor
FOR CD-135

27/10/2017

CPT/5

LANTERN RING FOR ASP CD-135

GGSS TP
CODE

02070228

(3.2) $\sqrt{6.3}$ ALLOWER

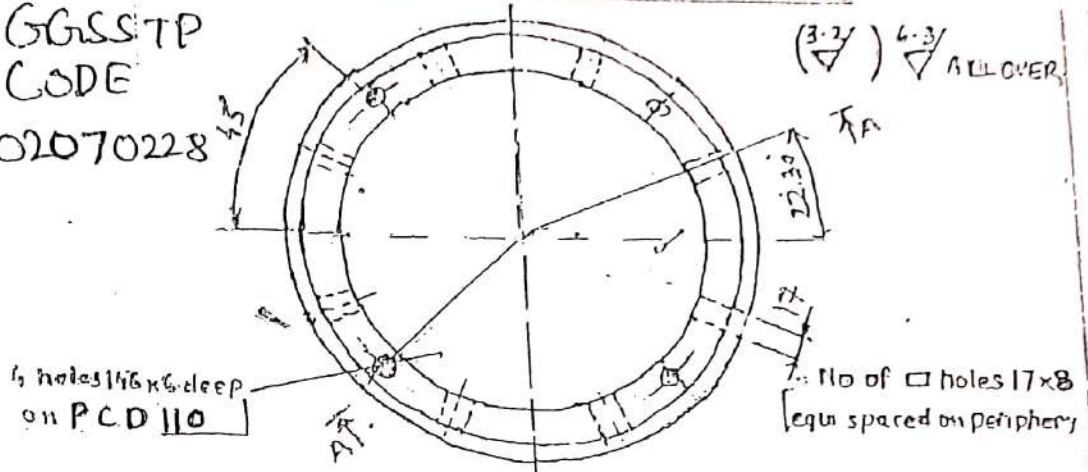

4 holes 146x6 deep on PCD 110

No of \square holes 17x8 equi spaced on periphery

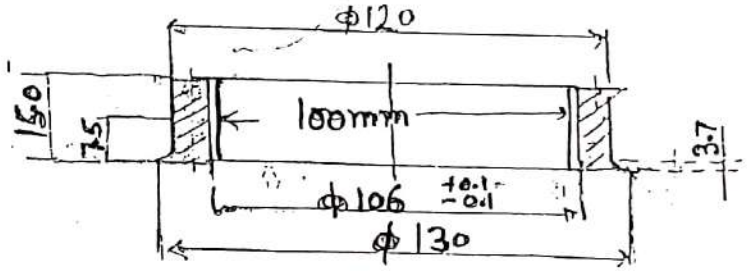

SEC-AA

Note: All dimensions are in mm

Material Bronze ASTM-B2 or equivalent

SKETCH-'E'

fl
S. K. M. B. M. 2

CP-1/6

LANTERN RING FOR ASP D-85 D

7

GGSSTP
Code 02070314

(3.2) 6.3 ALL OVER

4 holes M6 x 6 deep
on P.C.D. 138

8 No. of ϕ holes 17x8
equi spaced on periphery

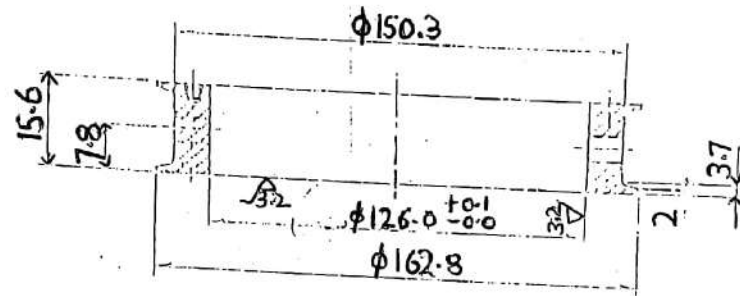
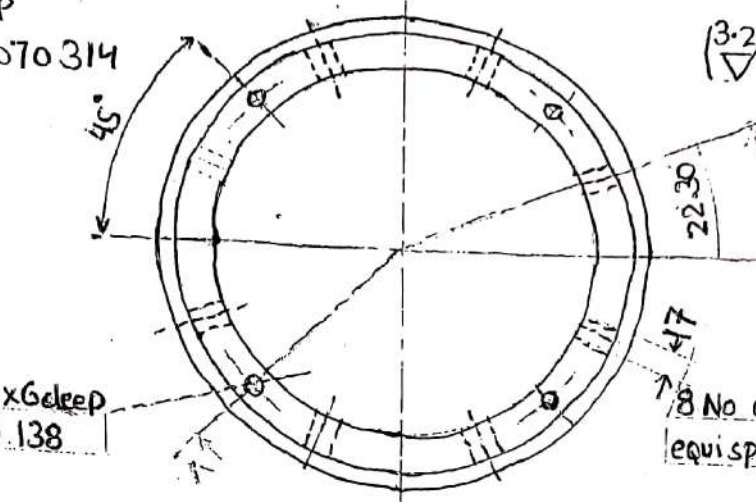

SEC-AA

1. All dimensions are in mm
2. Material Bronze ASTM-B-62 or equivalent

SKETCH - 'G'

SKETCH - BM-2

SKETCH - I

CODE 02080213

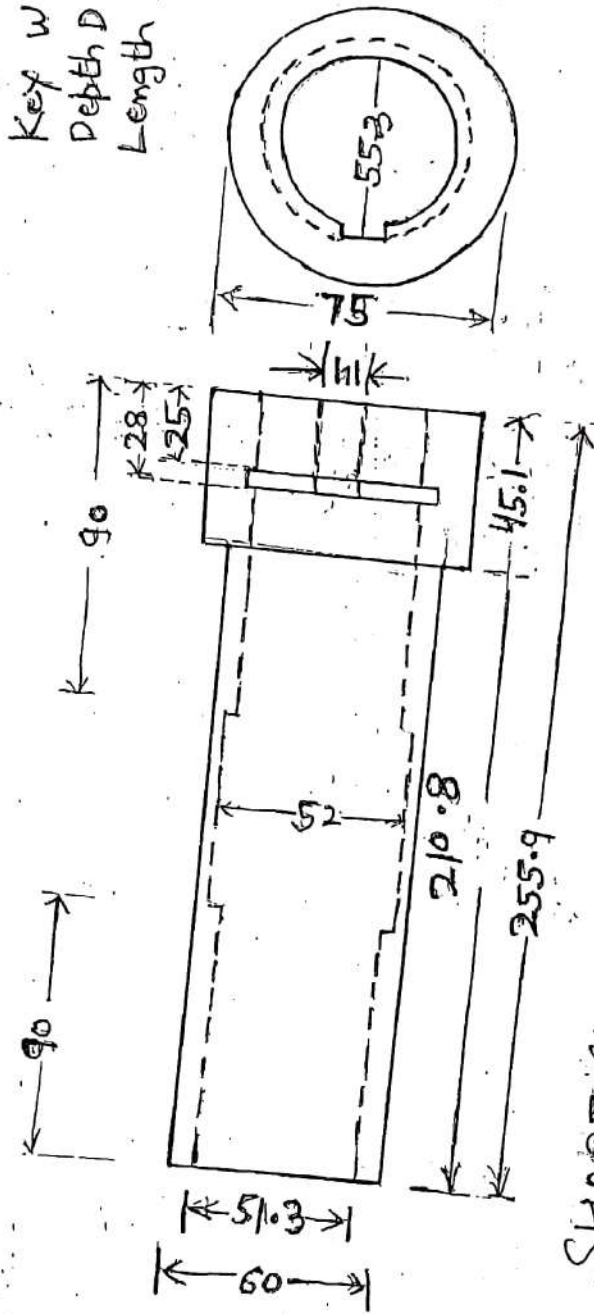

Key $w = 14 \text{ mm}$
 Depth $D = 4 \text{ mm}$
 Length = 25 mm

SHAFT-SLEEVE BAW PUMP-III

MATERIAL SS-304

Signature
 Section - BM-2

GGSS TP CODE 02080310 SKETCH - 'J'

CPY
8

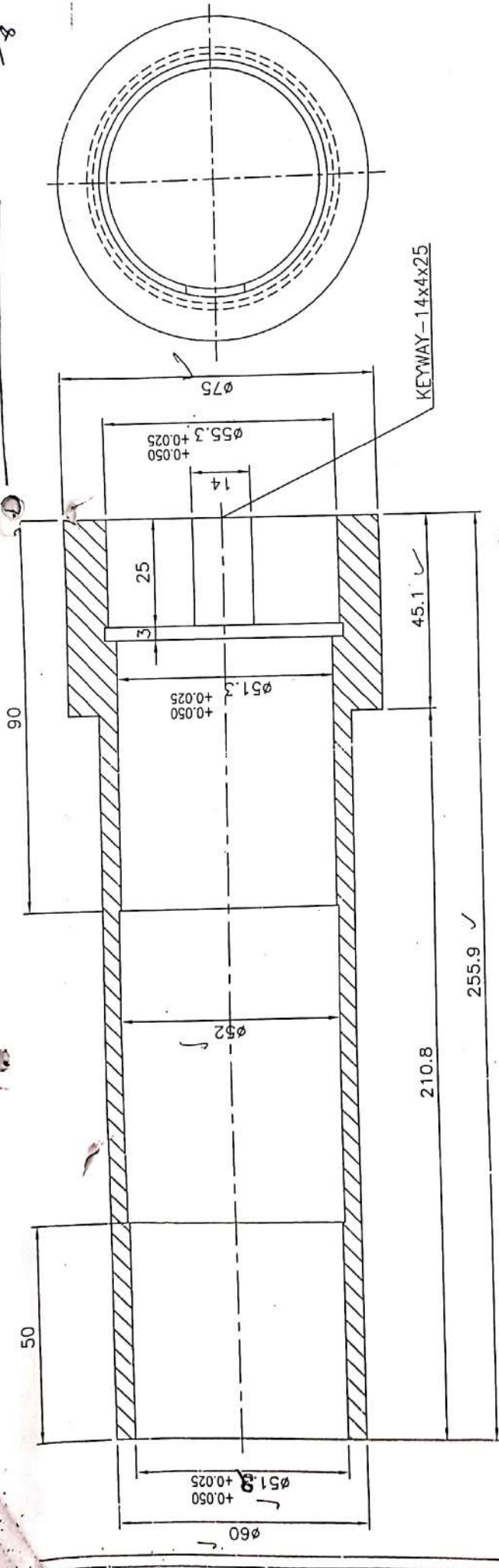

Handwritten signature and date: 18-11-2012

SHAFT SLEEVE FOR BAW PUMP
STAGE=III CODE NO. 02080310
MATERIAL = S.S-304

NOTES:

1. ALL DIMENSIONS ARE IN MM. UNLESS OTHERWISE STATED.
2. ~~ALL~~ MACHINED ALL OVER
3. TOLERANCE AS PER IS: SPECIFICATION
4. ALL SHARP EDGES TO BE ROUNDED OFF.

CP-1
9

SKETCH - I
GGSSTP CODE 02020201

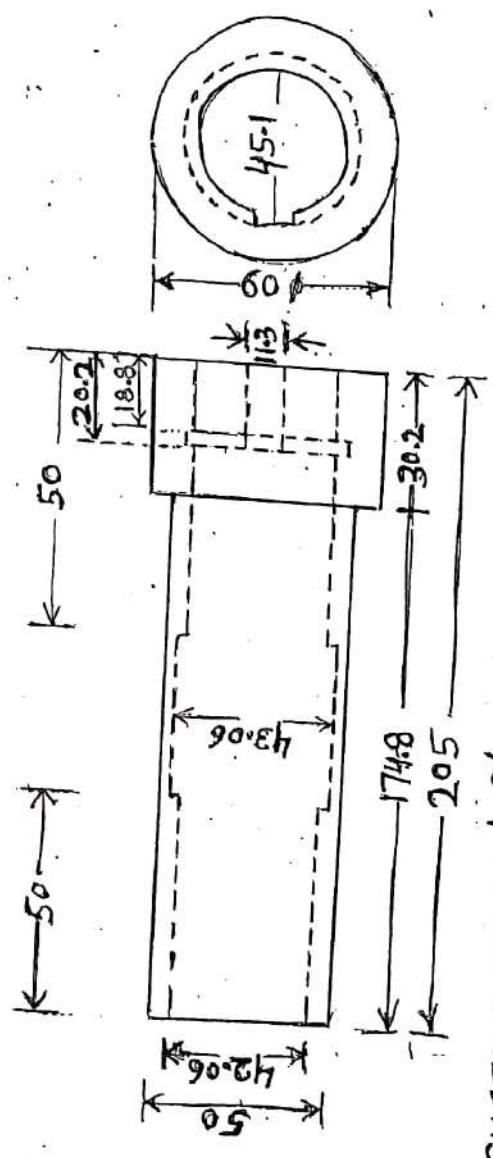

SHAFT SLEEVE LP/HP PUMP-II TYPE
MATERIAL SS-304

Handwritten signature and date: 20/11/2020

X

SKETCH (M)

GLAND FOLLOWER FOR HP/LP Stage-II

CODE 02080229

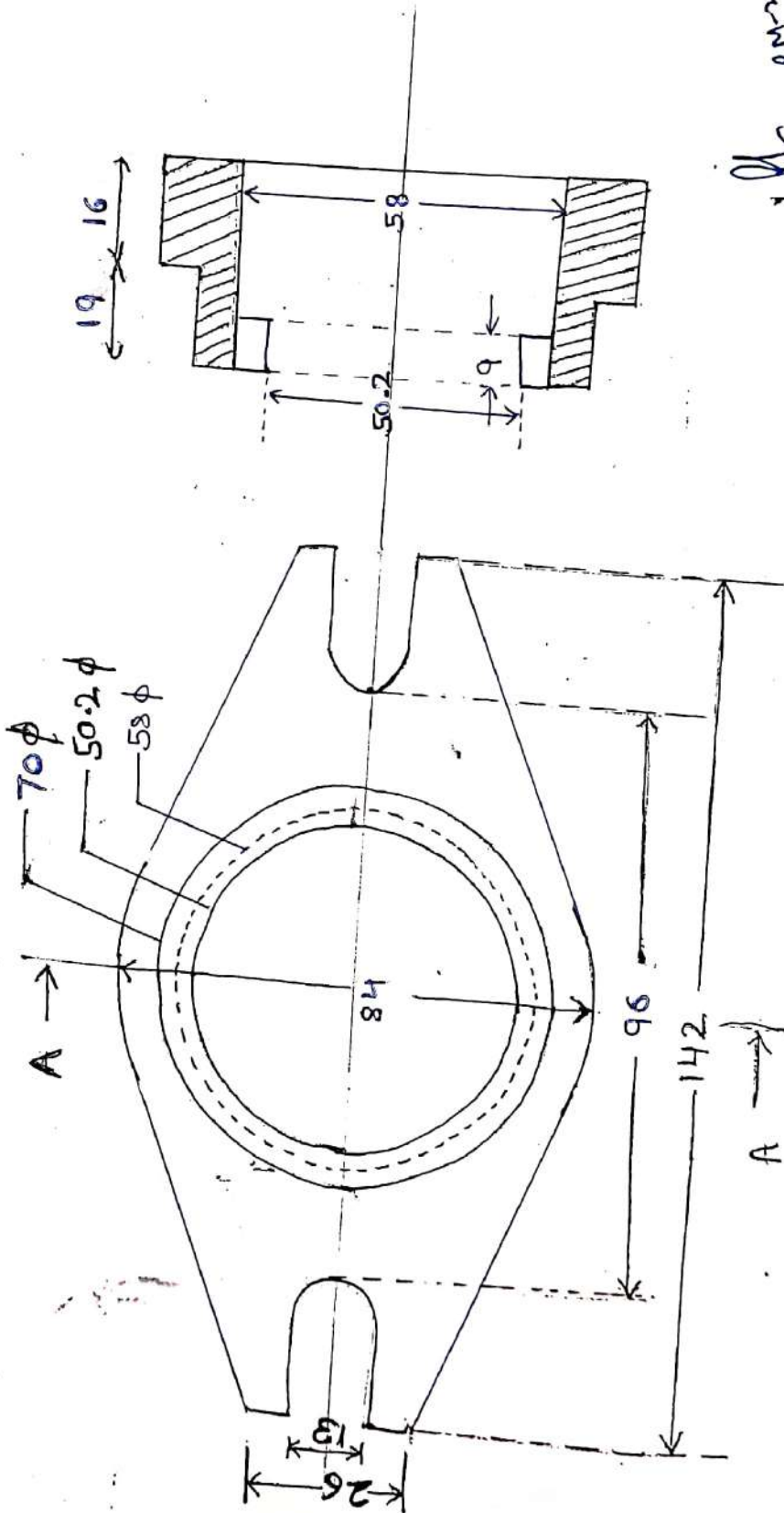

Dr. K. M. B. M. S.

- Note 1. All dimension are in mm
 2. Material CI as per IS 210 FG 260

SKETCH

GIGASSTP CODE 02080302

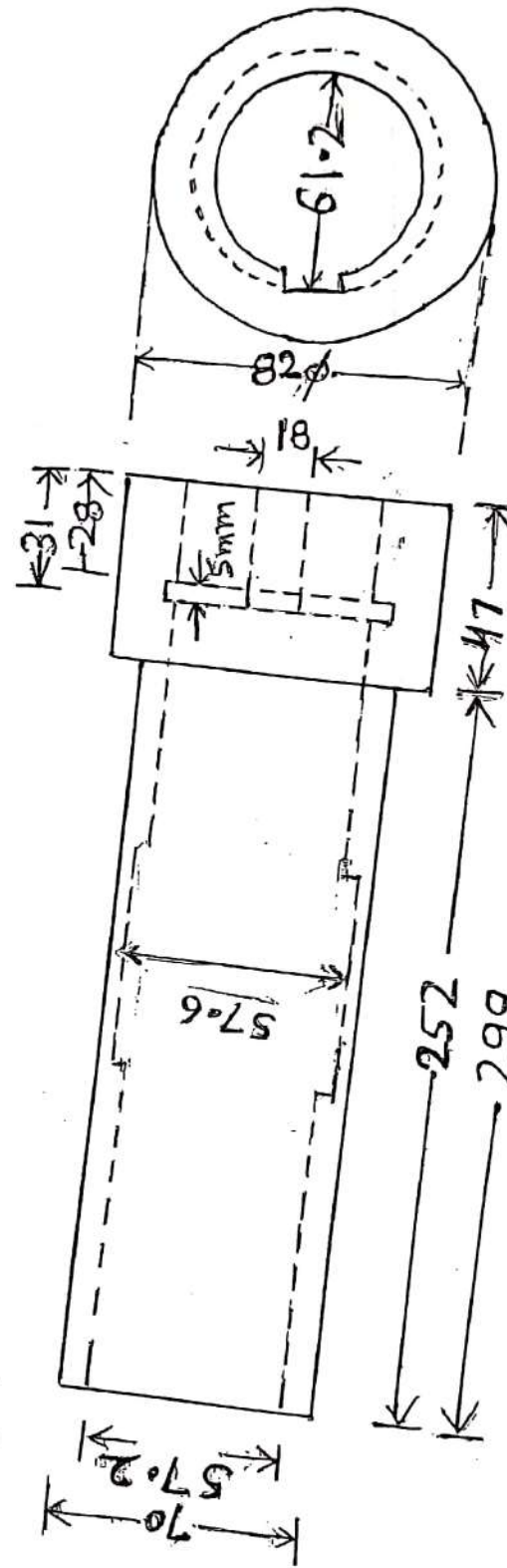

Shaft sleeve HP PUMP - III

MATERIAL - SS-304

Handwritten signature

CP-1
12

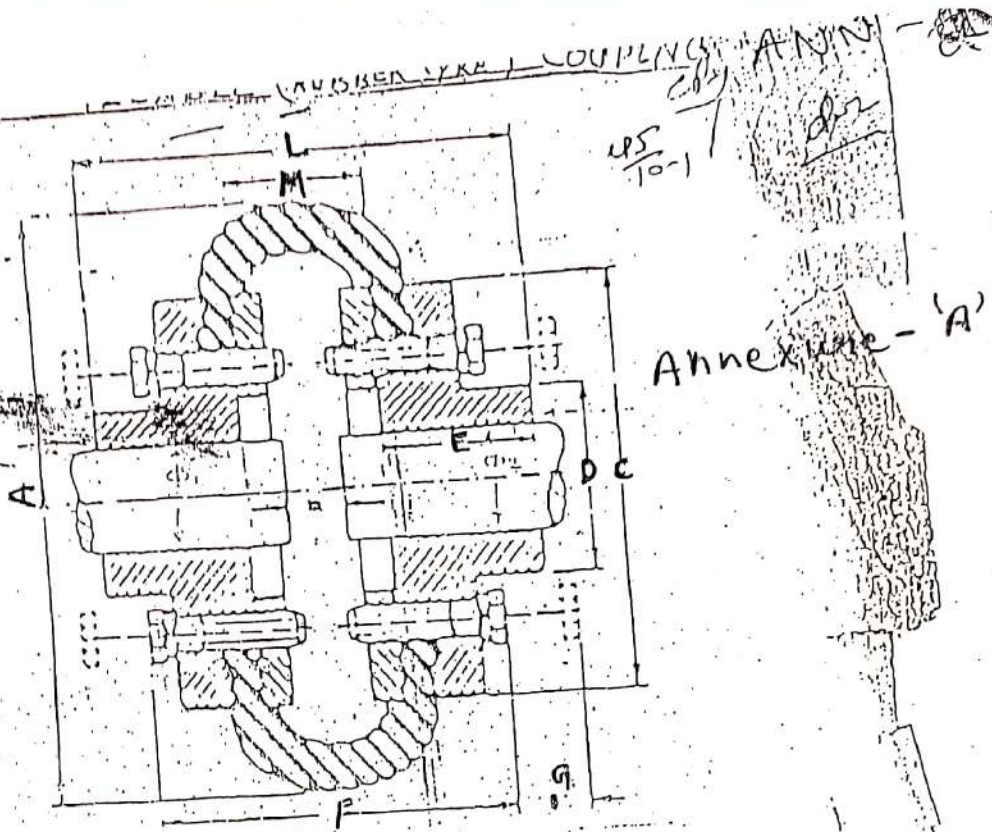

| SrNo | Name of Equipment | A | L | D | E | C | G | M | F | APPROX. WT. KG. |
|------|---|-----|-----|-----|----|-----|----|----|-----|-----------------|
| a | Seal Water Pump Stage III | 211 | 145 | 95 | 51 | 167 | 10 | 43 | 106 | 9.6 |
| b | Seal Water Pump Stage I + II | 177 | 130 | 82 | 45 | 144 | 10 | 40 | 101 | 6.2 |
| c | LP/HP Pump Stage II + HP Pump Stage III | 257 | 168 | 124 | 60 | 216 | 13 | 48 | 123 | 20 |
| d | LP Pump Stage III, BAW Stage II + III | 314 | 201 | 152 | 76 | 264 | 14 | 49 | 140 | 32 |

[Signature]
S. K. S. 2

Technical specification (overleaf)
PTO

a = 02080307
b =
c =
d = 02080215

2/2/20

SKETCH - 'P'

ADOPTER FOR FLUSHING APPARATUS NOZZLES

CODE 02030127

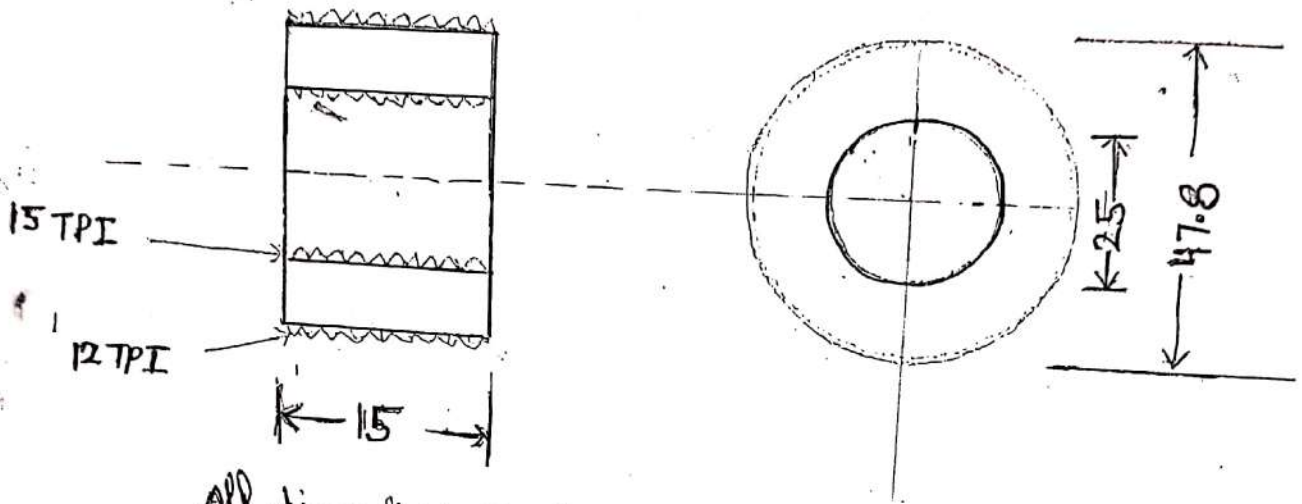

All dimensions are in mm

Material - M.S as per IS 228 tested quality

[Signature]
S. K. B. M. 2

CP-1
171

SKETCH 'R'

Code
020 10221

2 nos Additional glassstrips
Pasted

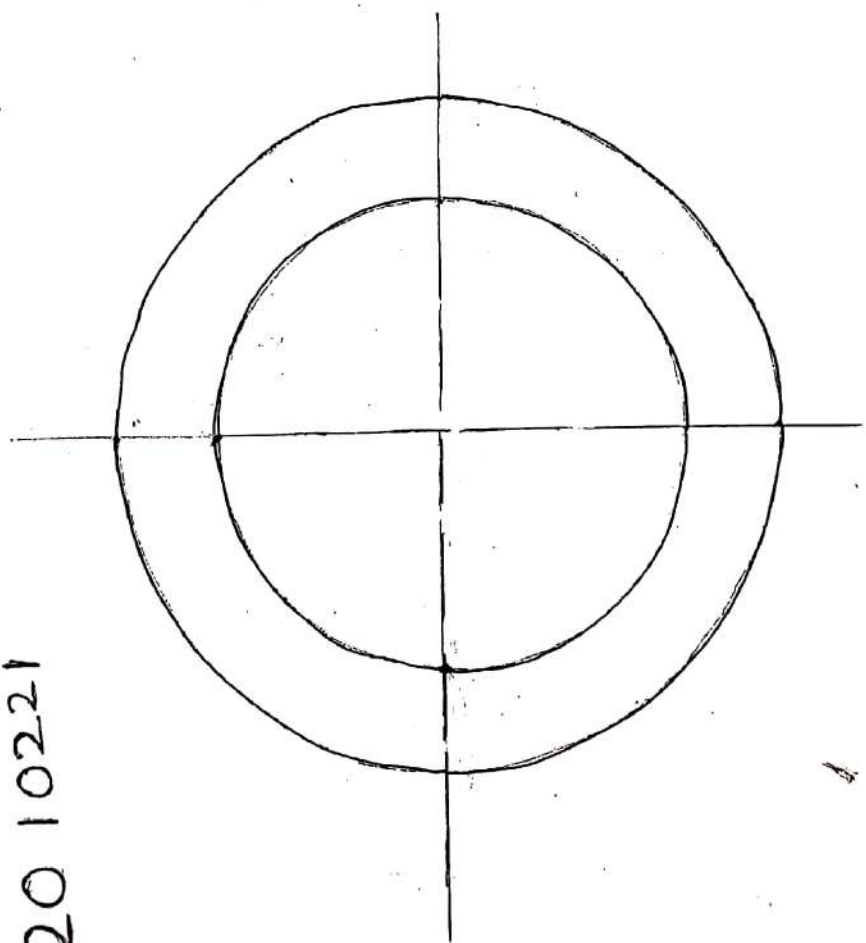
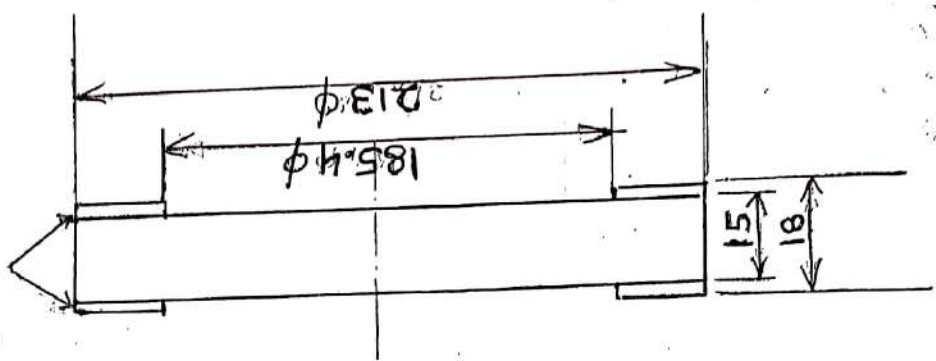

Handwritten signature and scribbles.

INSPECTION WINDOW TOUGHENED
GLASS FOR B.A.H.

CP-4
-15

GGSSTP Code: 02010134

SKETCH A (S)

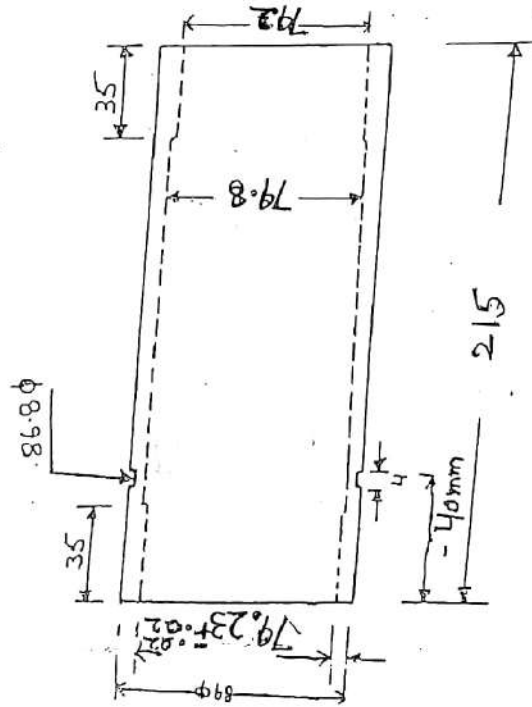

SHAFT SLEEVE FOR CLINKER GRINDER

MATERIAL - SS-304

25/05/2015

Signature
Date: 25-5-15

Sketch-10

Material Cast Iron as per

I.S. 210, Grade F

Note: This is a tentative sketch. estimation purpose. However can be seen at the site

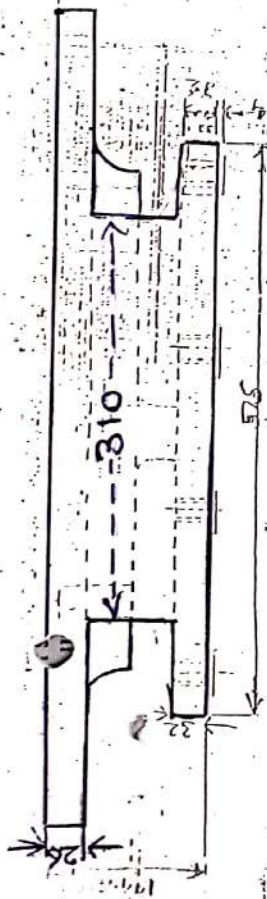

Code 02010167

199 through hole

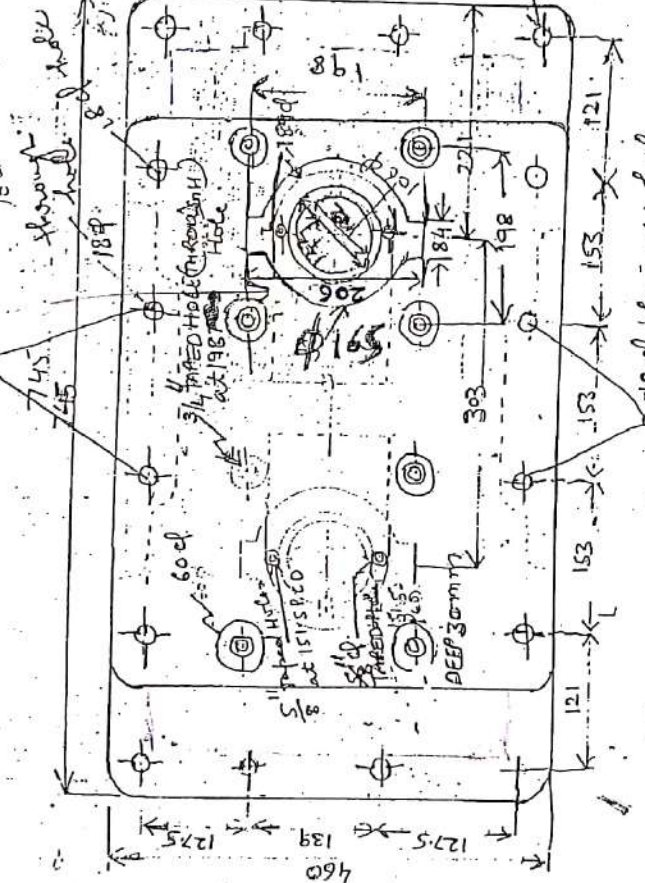

All dimensions are in mm

BEARING HSG. SUPPORT OF CLINKER GRINDER

Signature/Date

CP-4
17

SKETCH - 'U'

Code- 02090301

12 NO, 30 mm hole
at 480 PCD

12 NO, 30 mm hole
at 480 PCD

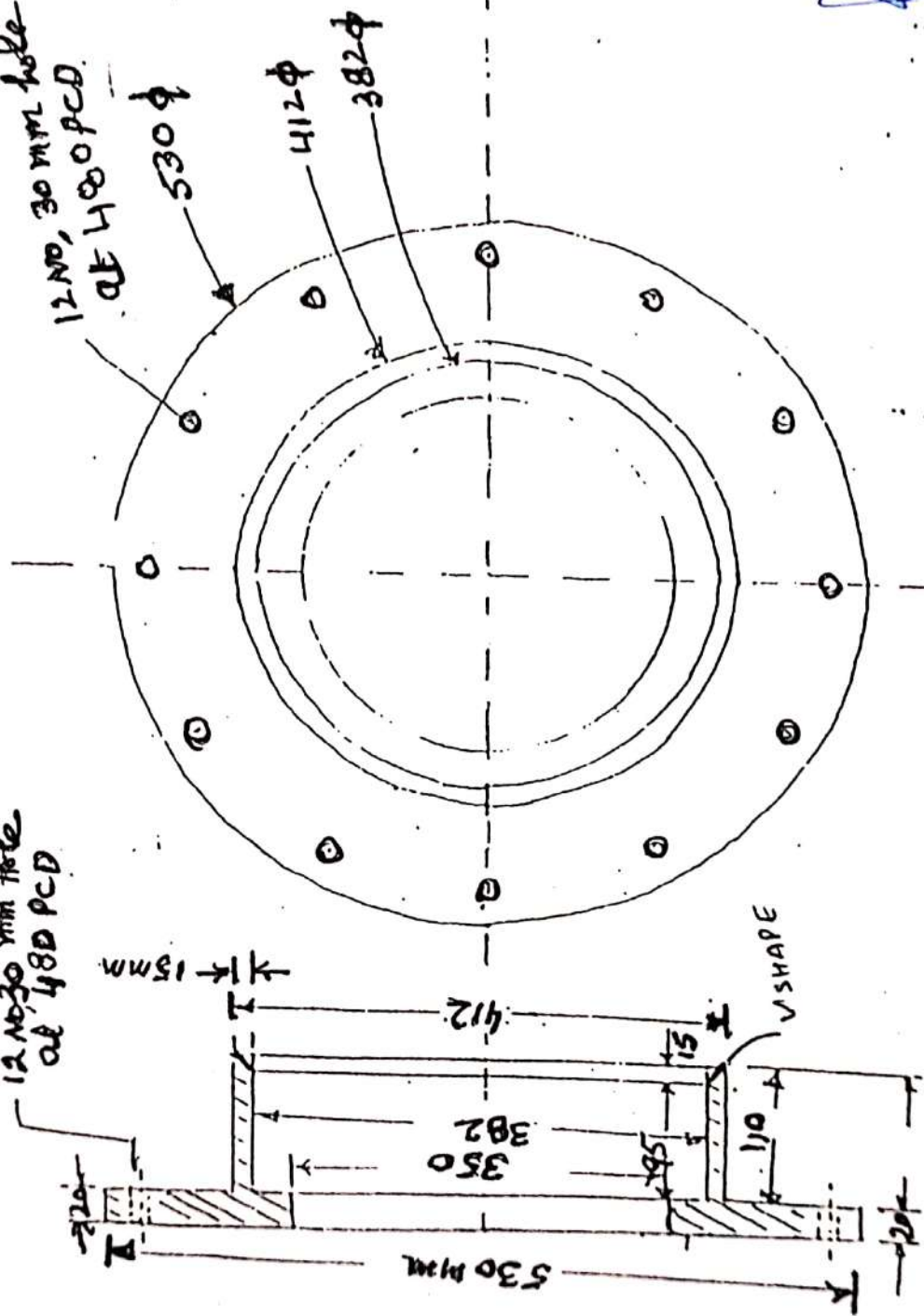

Surinder
2017-12-22

SUCTION ADAPTER FOR D-85-D PUMP

1. MATERIAL CI AS PER IS 210 F6.300
2. DRG IS FOR TENDERING PURPOSE ACTUAL SAMPLE CAN BE SEEN AT SITE